

# THORGEON

ENERGY METERS

## WIFI SMART PLUG

01012



Scan me

[www.thorgeon.com/01012](http://www.thorgeon.com/01012)



tuya<sup>®</sup>



230V

A

16

Hz

50-60

W<sup>max</sup>

3680



[www.thorgeon.com](http://www.thorgeon.com)

SIA "ATTA-1", Daugavgrivas street 77  
Riga, Latvia, LV-1007

4751029899439

Developed in Latvia

## Electrical specifications

| Item                    | Evaluation parameter                  | Detection level | Test environment  |
|-------------------------|---------------------------------------|-----------------|---|
| Rated voltage           | AC230V                                | 100% inspection | (humidity $\leq$ 65%)<br>Temperature $25\pm 1\text{C}$ ,<br>Humidity $\leq$ 65%<br>No air convection,<br>Using standard connector test. |
| Input voltage           | AC100-240V                            |                 |   |
| Rated load Current      | MAX 16A                               |                 |   |
| Load                    | MAX 3680W                             |                 |   |
| Wireless type           | WIFI 2.4G                             |                 |   |
| WIFI standard           | IEEE<br>802.11b/g/n (passageway 1-14) |                 |   |
| Guiding lights          | 1pc blue                              |                 |   |
| Over current protection | 16A(Adjustable)                       |                 | Automatic cut-off relay in 15 seconds   |
| Over voltage protection | 265V(Adjustable)                      |                 | Automatic cut-off relay in 15 seconds   |

## Technical Parameters:

| Item     | Parameter       |
|----------|-----------------|
| Width    | 50mm            |
| Height   | 84mm            |
| Plug     | EU              |
| Weight   | 83g             |
| Material | Plastic + Metal |

1. Power Supply: AC 110V~240V, 50Hz/60Hz;
2. Max Current: 16A Resistive;
3. Standby Consumption: <0.4W/H;
4. Working Consumption: <1.3W;
5. Working Temperature: -20 C ~ +60 C;
6. Working Humidity: <80%;
7. Plastic: V0 PC;
8. Network: 2.4Ghz 802.11 b/g/n;
9. Security type: WPA/WPA2

1. app control;
2. Timing;
3. Remote Control;
4. Voice control works with Amazon Alexa and Google Home
5. Energy Monitoring

## Dimension drawings

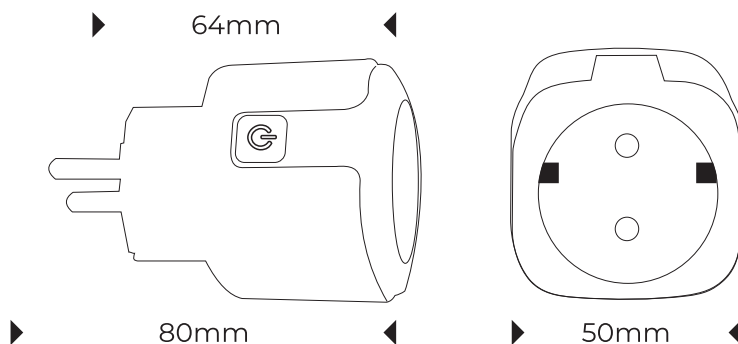

WiFi wireless communication technology is adopted to realize the traditional sockets. With Tuya WiFi app can remote switch, timing switch and so on.

### 2. Structural features

Jack protection: the jack is equipped with an independent safety door to protect the baby

Over current protection: if the working current greater than the rated working current, the relay will be cut off.



Flame retardant protection: V0 grade anti flame retardant material, which makes the protection equipment more durable;

### Note:

1. When the Smart socket use initial distribution network, the load cannot be connected. After the distribution network is successful, the load can be connected under known working conditions

2. When using socket, all over current functions are auxiliary functions, and the external circuit must be connected with a special leakage short-circuit protection device.

### ► How to connect Smart Plug to Wi-Fi network

1. Download Smart Life from  or .
2. Download or scan the QR code and install the Smart Life App for either iOS and Android. Once downloaded, the app will ask you to register your device. Enter your email, you will receive a text with a registration code. you will then create a password.



Attention: There's no Registration Code needed if email method chosen.

### ► Connect with mobile phone (Auto Scan)

1. Turn on the smart phone or device Bluetooth function and ensure the smart phone or device network is ON.
2. Before connecting, please make sure your smart phone or device is connecting with your home Wi-Fi 2.4GHz successfully.
3. Make sure quick mode configuration is initiated: the indicator light blinks blue rapidly (twice per second). If it blinks blue slowly (once every 3 seconds), press and hold the power button on the Smart Plug for 6 seconds until the indicator light blinks rapidly.
4. Open the application, click "+" to select "Auto Scan Mode", and then start to automatically scan products that can be connected.
5. Once connected, the App will prompt the connection, then click "Done".

① Into the home page

② Auto Scan

③ Enter the Wifi password

④ The equipment connected to the Internet

⑤ Distribution network success

⑥ Jump to the user panel

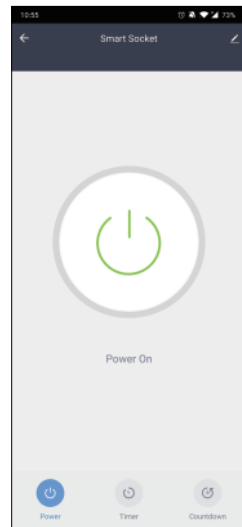
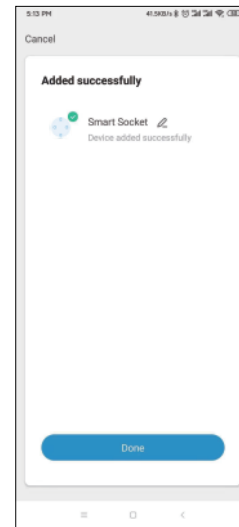
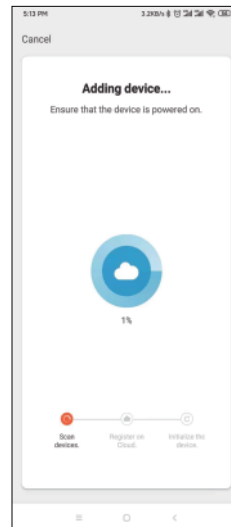
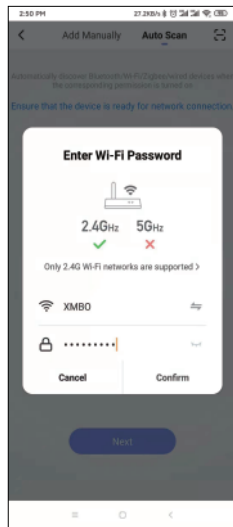
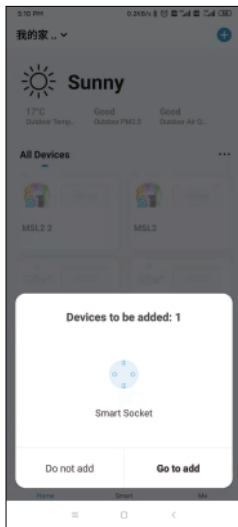
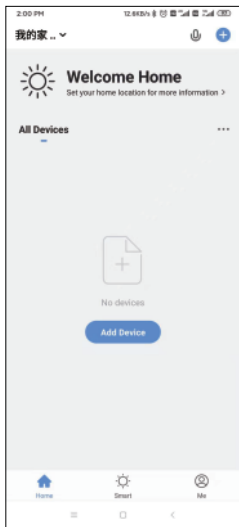

### ► Connect with mobile phone (Add Manually)

1. Turn on the smart phone or device Bluetooth function and ensure the smart phone or device network is ON.
2. Before connecting, please make sure your smart phone or device is connecting with your home Wi-Fi 2.4GHz successfully.
3. Make sure quick mode configuration is initiated: the indicator light blinks blue rapidly (twice per second). If it blinks blue slowly (once every 3 seconds), press and hold the power button on the Smart Plug for 6 seconds until the indicator light blinks rapidly.
4. Open the app, to scan QR code and see the guideline of pairing mode.



## ► Support 3rd Party Control

① Type the edit menu of the user panel.

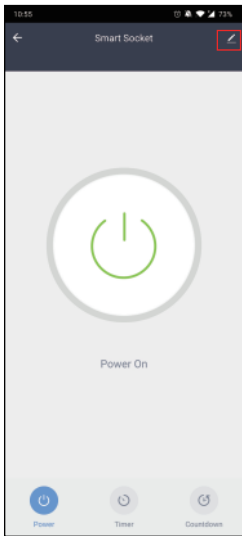

② Select the third-party application to be operated.

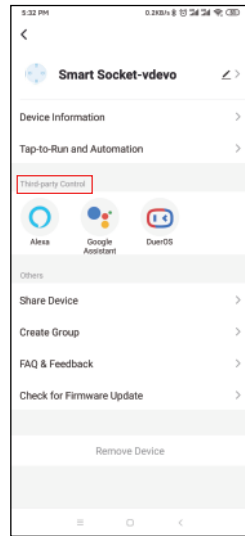

③ Follow the instructions in the tutorial to connect and use.

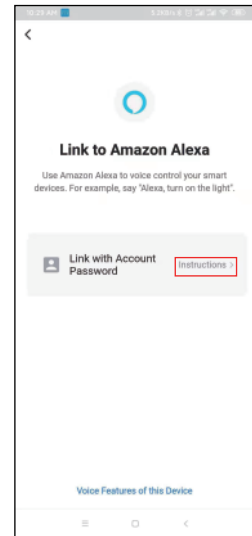
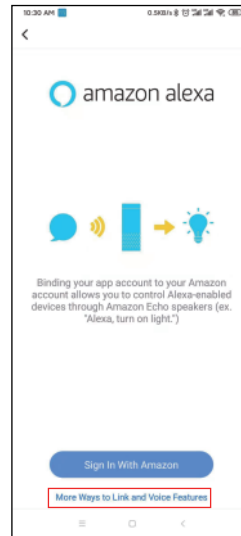

## FCC Statement

This device complies with part 15 of the FCC Rules. Operation is subject to the following two conditions: [1] This device may not cause harmful interference, and [2] this device must accept any interference received, including interference that may cause undesired operation.

## RF Exposure Information

The device has been evaluated to meet general RF exposure requirement. The device can be used in portable exposure condition without restriction.

## Warm Tips

- Please check whether the device is connected with power and your phone is connected with Wi-Fi.
- Check routers: If the router is dual-band router, please select a 2.4GHz network to add device. You also need to open the router broadcasting function.
- Set up the wireless router: Set encryption method as WPA2-PSK authorization type as AES, or set both as auto. The Wireless mode cannot be only 5GHz. Please name router Wi-Fi in English. In order to stay strong Wi-Fi signal, please keep device and router within a certain distance.
- Check whether connected devices have reached the Maximum number router connection. If so, please try to turn off the Wi-Fi connection of some devices.
- Make sure router wireless MAC filtering function is enabled.
- Remove the device from the filter list and make sure that router is not prohibiting device from connection.
- Make sure the entered password is correct when adding a new device.